

LEASEHOLD



Apartment (EPC Rating: C)

LONDON ROAD KINGSTON KT2 6QJ

Asking Price

£350,000



2 Bedroom Apartment located in Kingston

Chain Free! Ideal first time purchase within walking distance of Kingston town centre, Kingston Hospital & Richmond Park. Accommodation comprises TWO bedrooms, large open plan lounge with a modern fitted kitchen. Bathroom with shower over bath. Additional benefits include a communal rear garden. Leasehold, 90 years remaining, service charge £1500P/A, ground rent £400.

Approximate Area = 573 sq ft / 53.2 sq m
For identification only - Not to scale

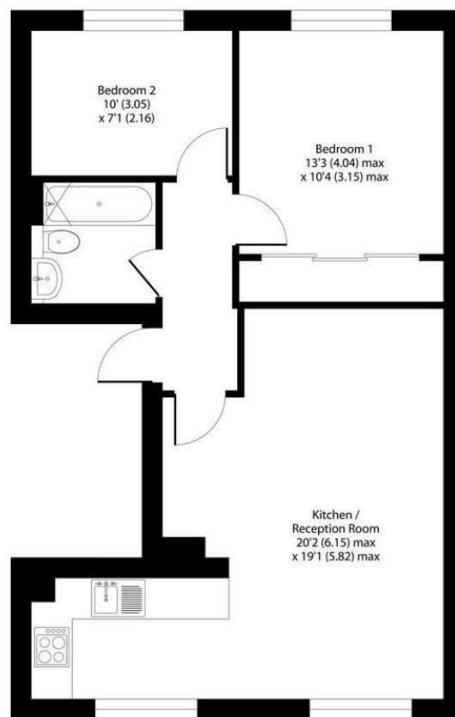

Council Tax Band

C

Energy Performance Graph

Energy Efficiency Rating		Current	Potential
Very energy efficient - lower running costs			
(92 plus) A			
(81-91) B			
(69-80) C		71	81
(55-68) D			
(39-54) E			
(21-38) F			
(1-20) G			
Not energy efficient - higher running costs			
England & Wales		EU Directive 2002/91/EC	

Call us on

020 8546 7771

info@saxonkings.co.uk

www.saxonkings.co.uk

Agents Note: Whilst every care has been taken to prepare these particulars, they are for guidance purposes only. All measurements are approximate and are for general guidance purposes only and whilst every care has been taken to ensure their accuracy, they should not be relied upon and potential buyers are advised to recheck the measurements.

