



LEASEHOLD

Apartment

# PARK ROAD, KINGSTON KT2 6DQ

Asking Price

# £375,000

## FEATURES

- Two double bedrooms
- Split level
- Walk to Richmond Park
- Bathroom and additional WC
- Walk to Norbiton station
- Own entrance



# 2 Bedroom Apartment located in Kingston

A well presented split level maisonette with its own entrance. Perfectly located just half a mile from Norbiton station and a short walk from Richmond Park, Kingston Hospital & local amenities (including a Co-Op and Ofsted Outstanding school). Accommodation comprises two double bedrooms, one reception room, separate modern kitchen, bathroom and additional W.C. Permit parking available. 117 years remaining on the lease, £100p/a Ground Rent, no service charge.

Call us on  
020 8546 7771

info@saxonkings.co.uk  
www.saxonkings.co.uk

Council Tax Band  
D

Approximate Gross Internal Area = 76 sq m / 818 sq ft

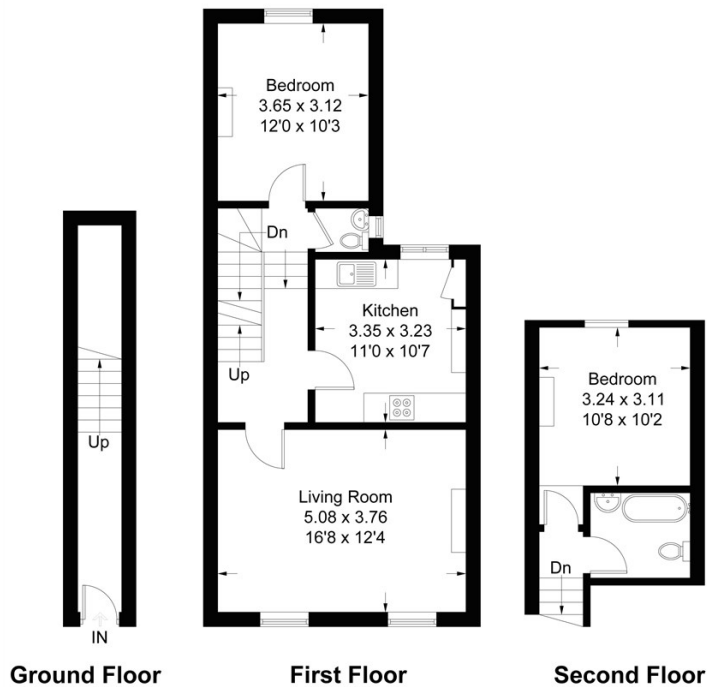

Energy Efficiency Rating		Current	Potential
<i>Very energy efficient - lower running costs</i>			
(92 plus)	A		
(81-91)	B		
(69-80)	C		
(55-68)	D	69	75
(39-54)	E		
(21-38)	F		
(1-20)	G		
<i>Not energy efficient - higher running costs</i>			
<b>England &amp; Wales</b>		EU Directive 2002/91/EC	

Agents Note: Whilst every care has been taken to prepare these particulars, they are for guidance purposes only. All measurements are approximate and are for general guidance purposes only and whilst every care has been taken to ensure their accuracy, they should not be relied upon and potential buyers are advised to recheck the measurements.

